

CENTURY 21®

Judge Fite Company

The Ella B

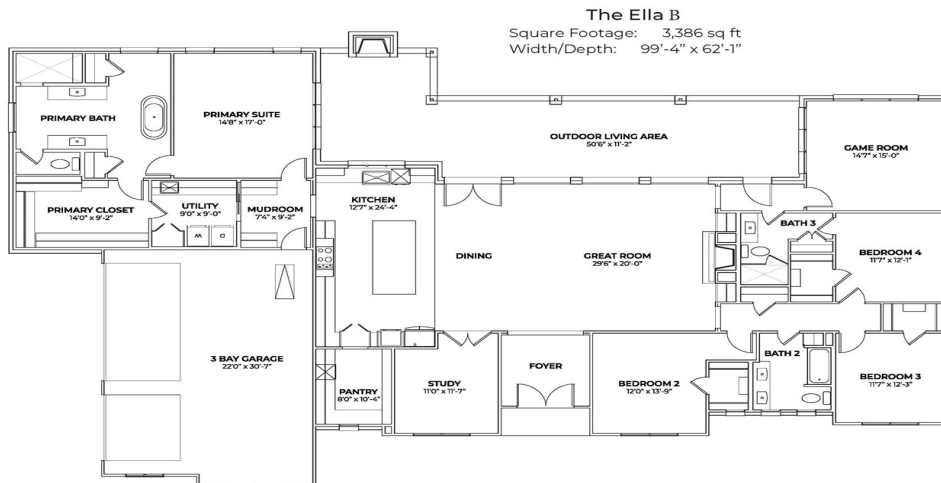

www.killiancustomhomes.com



6271 MCCHESENEY DRIVE

MIDLOTHIAN, TX 76065



\$860,000



3,386 sqft



4 beds



3 baths

DESCRIPTION

Stunning new construction Killian Custom Home on 1.5 acres — modern design and exceptional craftsmanship throughout. This spacious 4BR 3BA home offers 3,386 SF of thoughtfully designed living space perfect for family life and entertaining. Chef-inspired kitchen features oversized butler's pantry, quartz countertops, large center island and custom cabinetry. Open floorplan with generous living areas, private lot with tranquil setting, and minutes to schools, parks, shopping and other amenities. Photos are of same plan at a different address. Estimated completion by end of summer (just in time for school). Schedule showings or ask about current incentives with Danny Tutt at Killian Custom Homes.

PROPERTY TYPE: Residential - Single Family Residence

MLS STATUS: Active

MLS: 21195986

YEAR BUILT: 2026

COUNTY: Ellis

TRACT OR SUBDIVIION: Hartson Estates

LIST DATE: 03/03/2026

CENTURY 21

Judge Fite Company

800.451.8055

AREA:

SQUARE FEET: 3,386

TOTAL BEDS: 4

FULL BATHS: 3

HALF BATHS: 0

ACRES: 1.39

LOT SIZE (SQFT): 60,504

INTERIOR FEATURES

FIREPLACE:

- FamilyRoom
- GasStarter
- Outside

APPLIANCES:

- SomeGasAppliances
- ConvectionOven
- DoubleOven
- Dishwasher
- GasCooktop
- Disposal
- GasOven
- Microwave
- PlumbedForGas
- TanklessWaterHeater

VIRTUAL TOUR:

- [View virtual tour](#)

EXTERIOR FEATURES

STYLE:

- Farmhouse
- Modern
- Ranch
- Detached

PARKING:

- Concrete
- CommunityStructure

SIDING:

- Brick
- RadiantBarrier
- Rock
- Stone
- Stucco

POOL TYPE:

- None

UTILITIES

UTILITIES:

- Propane
- SepticAvailable
- WaterAvailable

ADDITIONAL PROPERTY DETAILS

AMENITIES:

- BuiltInFeatures
- DecorativeDesignerLightingFixtures
- DoubleVanity
- EatInKitchen
- KitchenIsland
- OpenFloorplan
- Other
- PanelingWainscoting
- NaturalWoodwork
- WalkInClosets

COMMUNITY:

- CommunityMailbox
-

LISTED BY: Melanie Brewer 

PHONE: 972.905.6333

BROKERED BY: Legacy Realty Group