

CENTURY 21

Judge Fite Company

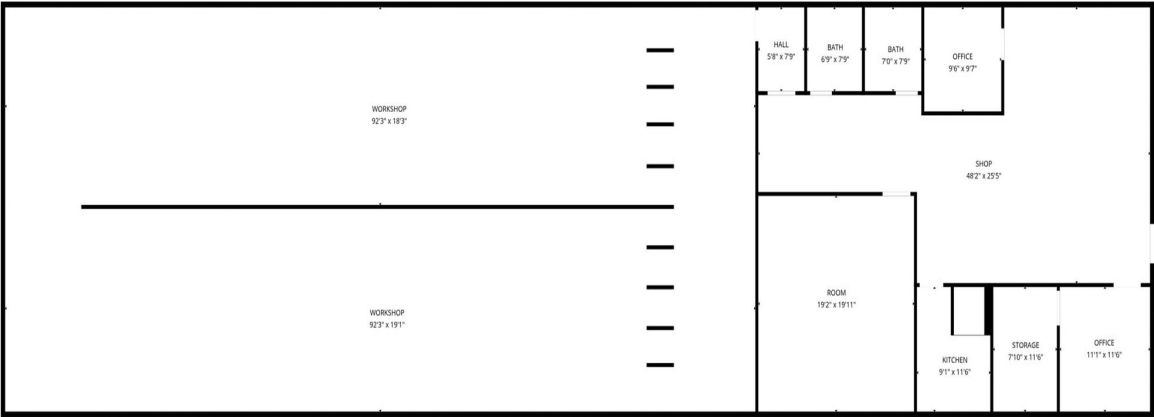

SIZES AND DIMENSIONS ARE APPROXIMATE, ACTUAL MAY VARY.

5321 E FM 1187

BURLESON, TX 76028



\$749,900



6,100 sqft

DESCRIPTION

Prime commercial opportunity off 1187 and outside city limits! This 6,000 sq. ft. building offers versatile space with 2 offices, 2 bathrooms, a large training room, and a break room. The back 4,000 sq. ft. was previously used as a gun range but can be repurposed to fit your business needs. Ample parking is available at the front, side, and back of the building, with additional room to expand if desired. Located within 10 minutes of Burleson, Mansfield, Fort Worth, and Alvarado, this property provides unbeatable accessibility in a high-demand area. Commercial buildings in this location are hard to find—don't miss your chance! Hurry and get your offer in NOW! LOCATION, LOCATION, LOCATION!!!

PROPERTY TYPE: Commercial - Industrial
MLS STATUS: Active
MLS: 21078091
YEAR BUILT: 2013
COUNTY: Tarrant
TRACT OR SUBDIVIION: Evergreen Crossing Add
LIST DATE: 04/17/2026

CENTURY 21

Judge Fite Company

800.451.8055

AREA:
SQUARE FEET: 6,100
TOTAL BEDS:
FULL BATHS:
HALF BATHS:
ACRES: 1.78
LOT SIZE (SQFT): 77,319

INTERIOR FEATURES

FLOOR COVERINGS:

- Other

VIRTUAL TOUR:

- [View virtual tour](#)

EXTERIOR FEATURES

PARKING:

- NoGarage
- Open
- Outside
- ParkingLot
- SharedDriveway
- Unpaved

LOT DESCRIPTION:

- InteriorLot

ROOF TYPE:

- Metal

SIDING:

- SteelSiding

FOUNDATION:

- Slab

UTILITIES

HEATING/COOLING:

- Central
- Electric

UTILITIES:

- ElectricityAvailable
- PhoneAvailable

ADDITIONAL PROPERTY DETAILS

LISTED BY: Kaylan Baucom 

BROKERED BY: EXP REALTY

century21judgefite.com

each office is independently owned and operated